

MECHANICAL HAND TOOL

for compression of end sleeves

PINCE MECANIQUE MANUELLE

pour embouts de câblage nus et préisolés

MECHANISCHE HANDZANGE

Für isolierte und nichtisolierte Aderendhülsen

HERRAMIENTA MECANICA MANUAL

para puntas huecas desnudas y preaisladas

UTENSILE MECCANICO MANUALE

per la compressione di tubetti terminali

HNKE...



ELECTRIC RISK: do not use this tool on live cables.

RISQUE ELECTRIQUE: ne pas utiliser l'outil sur des conducteurs sous tension.

ELEKTRISCHE GEFAHR: das Werkzeug ist nicht zum Arbeiten unter Spannung geeignet.

RIESGO ELÉCTRICO: no utilizar la herramienta sobre conductores en tensión.

RISCHIO ELETTRICO: non utilizzare l'utensile su conduttori in tensione.

	End sleeves	Weight
HNKE4	0.5 - 4 mm ²	498 g
HNKE16	4 - 16 mm ²	491 g
HNKE50	25 - 35 - 50 mm ²	590 g

mm

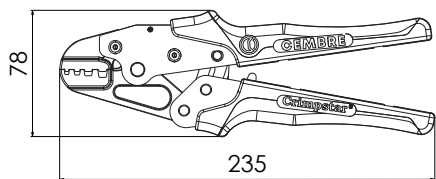

- Select the terminal according to the Copper conductor size used.
- Remove cable insulation over specified length.
Avoid damage to conductor strands.
Ensure cut face of insulation is neat and uniform.

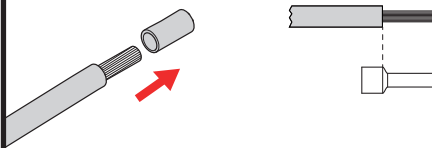

- 1 - Press the handle grips until the automatic opening.
- 2 - Correctly position the terminal into the corresponding tool die.

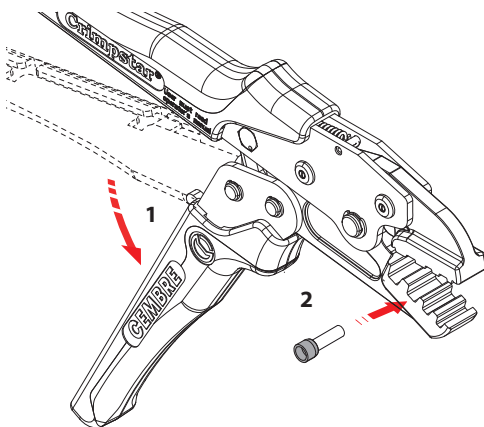

- 3 - Lock the terminal and fully insert the conductor.
- 4 - Proceed to crimp by completely pressing of the handle grips.

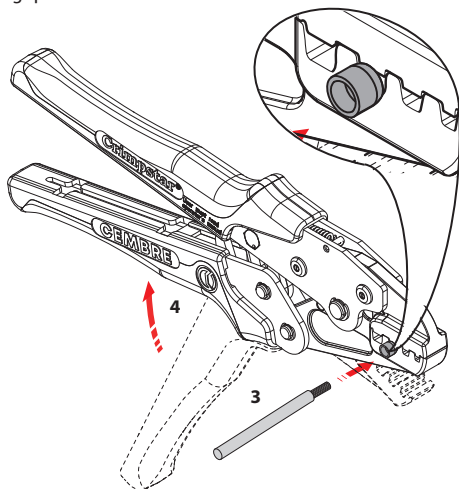

- 5 - Automatic re-opening of the handle grips.
- 6 - Remove the crimped terminal.

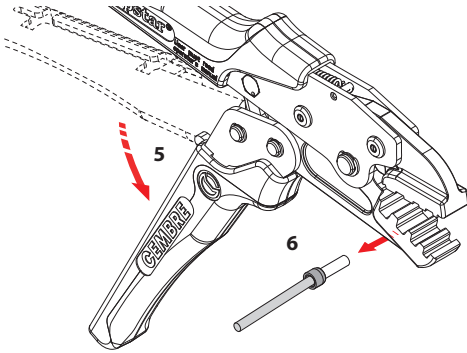

- Unlock the tool in case of need.

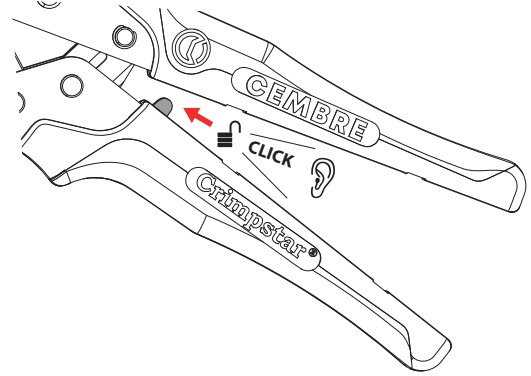

- Correct positioning of the terminal into the tool die.
- Depending on the connector length it may be necessary to perform 2 overlapping crimps.

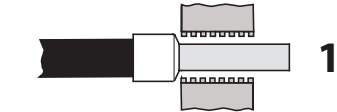

1

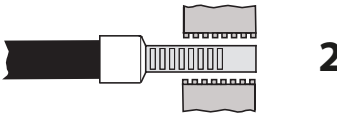

2

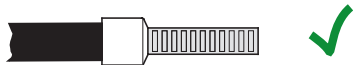

- Maintenance

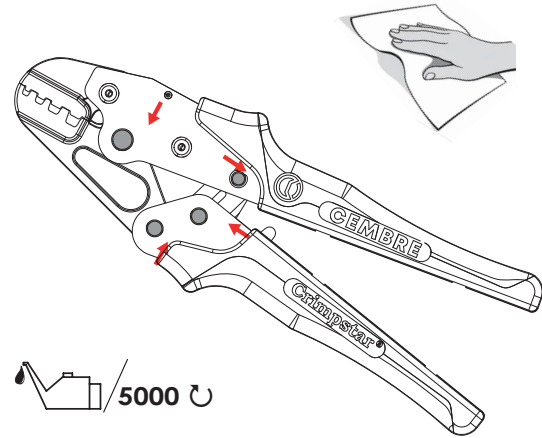

www.cembre.com

CEMBRE S.p.A.
via Serenissima, 9
25135 Brescia
Italy
Ph +39 030 36921
ufficio.vendite@cembre.com
sales@cembre.com

CEMBRE Ltd.
Dunton Park,
Kingsbury Road,
Curdworth, Sutton Coldfield
West Midlands, B76 9EB
United Kingdom
Ph +44 01675 470440
sales@cembre.co.uk

CEMBRE S.a.r.l.
22 Avenue Ferdinand
de Lesseps
91420 Morangis Cedex
France
Ph +33 01 60 49 11 90
info@cembre.fr

CEMBRE España S.L.U.
Calle Verano 6 y 8
Pl Las Monjas
28850 Torrejón de Ardoz
Madrid - Spain
Ph +34 91 4852580
comercial@cembre.com

CEMBRE GmbH
Geschäftsbereich
Energie- und Bahntechnik
Heidemannstr. 166
80939 München
Germany
Ph + 49 89-3580676
info@cembre.de



CEMBRE GmbH
Geschäftsbereich
Industrie und Handel
Boschstraße 7
71384 Weinstadt
Germany
Ph +49 7151-20536-60
info-w@cembre.de



CEMBRE Inc.
Raritan Center Business Park
300 Columbus Circle-5F,
Edison, NJ 08837 USA
Ph +1 (732) 225-7415
sales.us@cembre.com
Midwest Office
1051 Perimeter Dr. #470
Schaumburg, IL 60173

231135_0623_6260135